

A1

DO NOT SCALE

File: CP1770-BLP-ZZ-M2-MA-0040-0041-0042-00 Berth General Arrangement.dwg
Date: Jul 05, 2019 - 1:39pm
Plotted by: TJOConnell

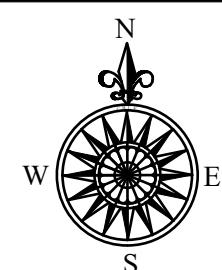
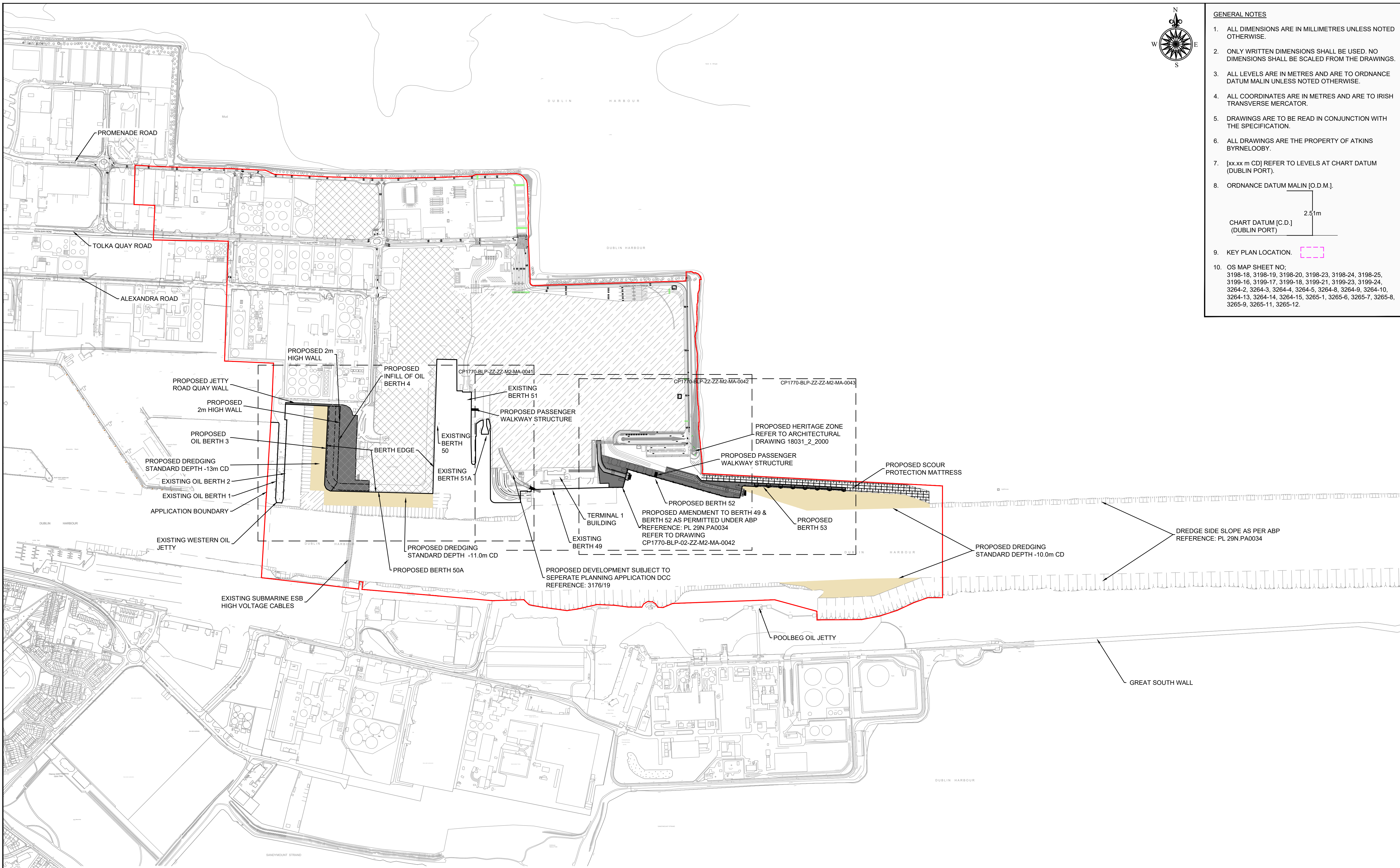

- GENERAL NOTES**
1. ALL DIMENSIONS ARE IN MILLIMETRES UNLESS NOTED OTHERWISE.
 2. ONLY WRITTEN DIMENSIONS SHALL BE USED. NO DIMENSIONS SHALL BE SCALED FROM THE DRAWINGS.
 3. ALL LEVELS ARE IN METRES AND ARE TO ORDNANCE DATUM MALIN UNLESS NOTED OTHERWISE.
 4. ALL COORDINATES ARE IN METRES AND ARE TO IRISH TRANSVERSE MERCATOR.
 5. DRAWINGS ARE TO BE READ IN CONJUNCTION WITH THE SPECIFICATION.
 6. ALL DRAWINGS ARE THE PROPERTY OF ATKINS BYRNELOOBY.
 7. [xx.xx m CD] REFER TO LEVELS AT CHART DATUM (DUBLIN PORT).
 8. ORDNANCE DATUM MALIN [O.D.M.].
- CHART DATUM [C.D.] (DUBLIN PORT) 2.51m
9. KEY PLAN LOCATION.
 10. OS MAP SHEET NO:
3198-18, 3198-19, 3198-20, 3198-23, 3198-24, 3198-25, 3199-16, 3199-17, 3199-18, 3199-21, 3199-23, 3199-24, 3264-2, 3264-3, 3264-4, 3264-5, 3264-8, 3264-9, 3264-10, 3264-13, 3264-14, 3264-15, 3265-1, 3265-6, 3265-7, 3265-8, 3265-9, 3265-11, 3265-12.

Ordnance Survey Ireland Licence No. EN 0061919
© Ordnance Survey Ireland/Government of Ireland

- | | | |
|---|---|---------------------------------|
| APPLICATION BOUNDARY | PROPOSED GANTRIES WITH VMS AND STATIC SIGNAGE | EXISTING 30m HIGHMAST LIGHTING |
| PROPOSED SCOUR PROTECTION MATTRESS ON SEA BED | PROPOSED 30m HIGHMAST LIGHTING | EXISTING LIGHTING |
| DREDGED SIDE SLOPES | PROPOSED 15m HIGHMAST LIGHTING | EXISTING STREET LIGHTING |
| PROPOSED DREDGED AREA | PROPOSED STREET LIGHTING | CONTAINER FREIGHT TERMINAL YARD |
| | PROPOSED CONCRETE DECK | UNIFIED FERRY TERMINAL YARD |

Rev	Description	By	Date	Chk'd	Auth
00	ISSUED FOR PLANNING	TJOC	07.19	SMC	AC

ATKINS
Member of the SNC-Lavalin Group

BYRNELOOBY
WS Atkins Ireland Ltd. & ByrneLooby Partners Ltd.
Atkins House,
150 Airside Business Park,
Swords, Co. Dublin

Client
**COMHLACHT CHALAFOR
ÁTHA CLIATH
DUBLIN PORT COMPANY**

Project
MP2

Purpose PLANNING	
Title OVERALL PROPOSED BERTH GENERAL ARRANGEMENT	
Original Scale 1:5,000 @A1	Design/Drawn TJOC
Date 28.09.18	Checked SMC
Date 28.09.18	Authorised AC
Date 28.09.18	Date 28.09.18
Status P	Drawing Number CP1770-BLP-ZZ-M2-MA-0040
	Rev 00